

# 2023

## ROW



BA123-243	BA121-300B	BA122-300B	BA121-308	BA122-308	BA123-308	BA123-3006	BA123-8X5	BA123-4570
-----------	------------	------------	-----------	-----------	-----------	------------	-----------	------------

	Item	Description	243 Win	300 Blackout	300 Blackout	308 Win	308 Win	308 Win	30-06 Spring	8x57 JRS	45-70 Govt
1 CAÑÓN / BARREL	TUBTD209C	32194R-STDØ17,2[8x57IRSP19,5E4L20CA]5/8USA									
	TUBTD502CR	32194R-BA13TD-STDØ17,2[308P1:12E6L20C]PAV 5/8EU									
	TUBTD503CR	32325R-BA13TD-STDØ19,1[308P1:8E6L16,5CAR]PAV EU									
	TUBTD504CR	32194R-BA13TD STDØ17,2[243P1:10E6L20C]PAV 5/8EU	X								
	TUBTD505CR	32325R-BA13TD-STDØ19,1[300AACP1:8E6L16,5C]5/8EU		X							
	TUBTD506CR	32364R-BA13TD-FULLØ19[45-70P1:20E6L20C]5/8EU									
	TUBTD507CR	32194R-BA13TD-STDØ17,2[30-06P1:10E6L20C]PAV5/8E									
	TUBTD515CR	40422-BA13TD-STDØ18,3[300AACP1:8E6L18C]5/8EU									
	TUBTD516CR	40422-BA13TD-STDØ18,3[308P1:8E6L18C]5/8EU									
	2 EXTRACTOR / EXTRACTOR	29955M	EXPULSOR DE MIM CAL.30-06	X							
30198M		EXPULSOR DE MIM CAL.45-70									
30202M		EXPULSOR DE MIM CAL.222		X	X						
3 CUBRE ROSCAS / THREAD PROTECTOR	30582N	CUBRE-ROSCAS	X	X	X	X	X	X	X	X	X
4 BASCULA / FRAME	BMETD002C	33162- BASCULA SC V2 TD BERGARA MECANIZADA NEGRA	X	X	X	X	X	X	X	X	X
5 MARTILLO / STRIKING PIECE	30952M	STRIKING PIECE - SCOUT 2 M4x0,35	X	X	X	X	X	X	X	X	X
6 MUELLE MARTILLO / STRIKING PIECE SPRING	30965	MUELLE MARTILLO SCOUT 2	X	X	X	X	X	X	X	X	X
7 LEVA DE CIERRE / LOCKING LEVER	32588	LEVER - SCOUT V2	X	X	X	X	X	X	X	X	X
8 MUELLE DE TRORSION / TORSION SPRING	30949C	MUELLE TRORSION FUERTE - SCOUT V2	X	X	X	X	X	X	X	X	X
9 PASADOR D=5 / D=5 PIN	31909	PASADOR - PIN 5x24	X	X	X	X	X	X	X	X	X
10 PASADOR LEVA DE CIERRE / LOCKING LEVER PIN	31905	PASADOR EJE DEL CIERRE	X	X	X	X	X	X	X	X	X
11 PERCUTOR / FIRING PIN	31183	EJE PERC.	X	X	X	X	X	X	X	X	X
12 MUELLE DE PERCUTOR / FIRING PIN SPRING	31198	MUELLE DEL PERCUTOR DEL APEX	X	X	X	X	X	X	X	X	X
13 TORNILLO RETENCION DE PERCUTOR / FIRING PIN RETAIN SCREW	31182	TORNILLO M4x8 DIN-7984	X	X	X	X	X	X	X	X	X
14 SPUR / HAMMER SPUR	31721	SPUR SCOUT M4x0,35	X	X	X	X	X	X	X	X	X
15 PASADOR TOPE APERTURA / OPENING STOP PIN	31949	PASADOR TOPE SC 2	X	X	X	X	X	X	X	X	X
16 MUELLE RETORNO MARTILLO / HAMMER RETURN SPRING	30982	MUELLE RETORNO SCOUT 2ª GEN	X	X	X	X	X	X	X	X	X
17 GUARDAMONTES / TRIGGER GUARD	30948	GUARDAMONTE SCOUT-OPTIMA V2 NEGRO	X	X	X	X	X	X	X	X	X
18 MUELLE GATILLO / TRIGGER SPRING	30944	PULLING PIECES SPRING - SCOUT II	X	X	X	X	X	X	X	X	X
19 GATILLO / TRIGGER	30943	PULLING PIECE SCOUT 2	X	X	X	X	X	X	X	X	X
20 LEVA APERTURA / OPENNING LEVER	31455	GARFIO OPTIMA V2	X	X	X	X	X	X	X	X	X
21 MUELLE LEVA APERTURA / OPENNING LEVER SPRING	30945	OPENNING LEVER SPRING - SCOUT II	X	X	X	X	X	X	X	X	X
22 REMACHE LEVA APERTURA / OPENNING LEVEL FIXING PIN	31859	FIXING PIN - SC 2	X	X	X	X	X	X	X	X	X
23 ESPACIADOR / BUSHING	31950	CASQUILLO - BUSHING	X	X	X	X	X	X	X	X	X
24 PASADOR D=10 / D=10 PIN	31907	PASADOR - PIN	X	X	X	X	X	X	X	X	X
25 TOPE REGULADOR / ADJUST SCREW	31873	TOPE ROSCADO	X	X	X	X	X	X	X	X	X
26 TUERCA DE BLOQUEO / BLOCKING NUT	28288	TUERCA M-5 DIN 934	X	X	X	X	X	X	X	X	X
27 VARILAL REGULACION / ADJUST ROD	32163	VARILLA ROSCADA M5x12 DIN 913	X	X	X	X	X	X	X	X	X
28 ESPARRAGO DE BLOQUEO / BLOCKING ROD	31539	ESPARRAGO ALLEN M3x3 DIN 913	X	X	X	X	X	X	X	X	X
29 CULATA / STOCK	30493N	THUMBHOLE STOCK NEGRO (PINTADO)	X	X	X	X	X	X	X	X	X
30 ARANDELA UNION CULATA BASCULA / FRAME-STOCK WASHER	W503241	WASHER B 8.4 DIN 125 (BLUED)	X	X	X	X	X	X	X	X	X
31 TORNILLO UNION CULATA-BASCULA / FRAME STOCK BOLT	31908	TORNILLO UNION	X	X	X	X	X	X	X	X	X
32 ESCUDO / GRIP	30743	GRIP CAP BERGARA	X	X	X	X	X	X	X	X	X
33 TORNILLO AMARRE ESCUADO / GRIP CUP SCREW	32258	TORNILLO M4x30 DIN 966	X	X	X	X	X	X	X	X	X
34 CANTONERA / RECOIL PAD	29891B	CANTONERA BERGARA - BREAK ACTIONCANTONER	X	X	X	X	X	X	X	X	X
35 TORNILLO AMARRE CANTONERA / RECOIL PAD SCREW	10448	TOR. CAB. AVELL.3,5x30 DIN 7505A	X	X	X	X	X	X	X	X	X
36 GUARDAMANOS / FOREHAND	32156N	GUARDAMANOS SCOUT TAKE DOWN PINTADO NEGR	X	X	X	X	X	X	X	X	X
	32156VN	GUARDAMANOS SCOUT T.D. PINTADO NEGR F.C.									X
37 TAPON ROSCADO / SCREW CAP	29256	TAPON ORIFICIO A-M	X	X	X	X	X	X	X	X	X
38 TORNILLO CARRIL / TRACK SCREW	30206.1	TORNILLO BASE M.T.	X	X	X	X	X	X	X	X	X
39 PASADOR EXTRACTOR / EXTRACTOR PIN	30209	PASADOR ESPIRAL DE 3 x 14 DIN 7343	X	X	X	X	X	X	X	X	X
40 MUELLE EXTRACTOR / EXTRACTOR SPRING	30238	MUELLE DEL EXTRACTOR	X	X	X	X	X	X	X	X	X
41 CARRIL / TRACK	30632AP	BASE PICATINNY D=25,4 PINTADA	X	X	X	X	X	X	X	X	X
42 ESTRUCTURA INTERIOR / INTERNAL STRUCTURE	32146B	ESTRUCTURA INTERIOR	X	X	X	X	X	X	X	X	X
43 TORNILLO AMARRE / LOCKING SCREW	32145	TORNILLO M4x16	X	X	X	X	X	X	X	X	X
44 PASADOR DE PALANCA / HAND LEVER SPRING	31552	PASADOR DE PALANCA DE GUARDAMANO	X	X	X	X	X	X	X	X	X
45 PALANCA / HAND LEVER	32155	PALANCA	X	X	X	X	X	X	X	X	X
46 MUELLE DE PALANCA / HAND LEVER SPRING	32152	MUELLE PALANCA	X	X	X	X	X	X	X	X	X
47 PASADOR ELASTICO Ø2x16 / Ø2x16 ELASTIC PIN	32150	PASADOR ELASTICO Ø2x16 DIN7343	X	X	X	X	X	X	X	X	X
48 PASADOR ELASTICO Ø2x8 / Ø2x8 ELASTIC PIN	32151	PASADOR ELASTICO Ø2x8 DIN7343	X	X	X	X	X	X	X	X	X
49 PORTA CORREAS / SWIVEL SCREW	29116	BACK SCREW	X	X	X	X	X	X	X	X	X

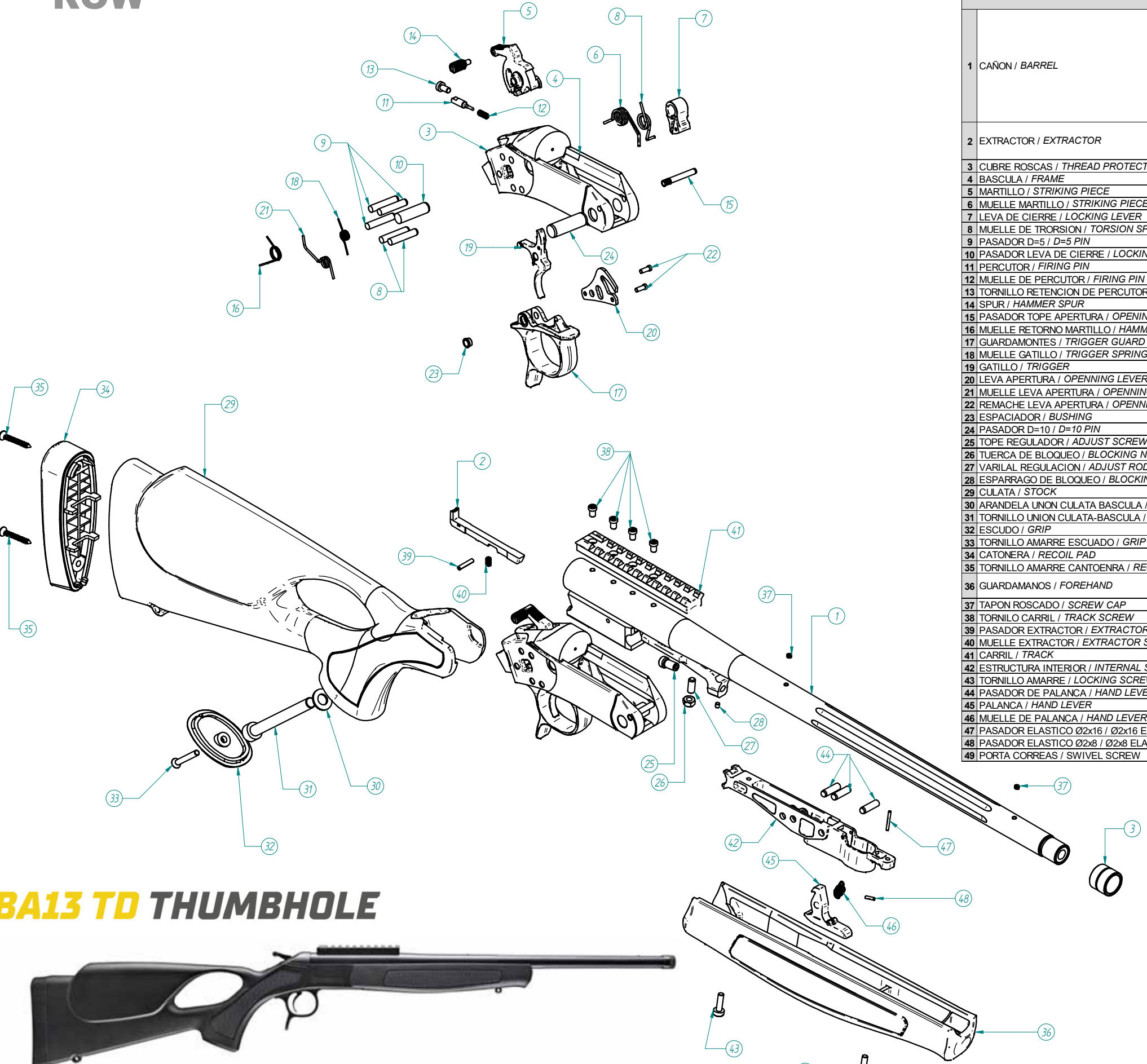

### BA13 TD THUMBHOLE