

2023

ROW

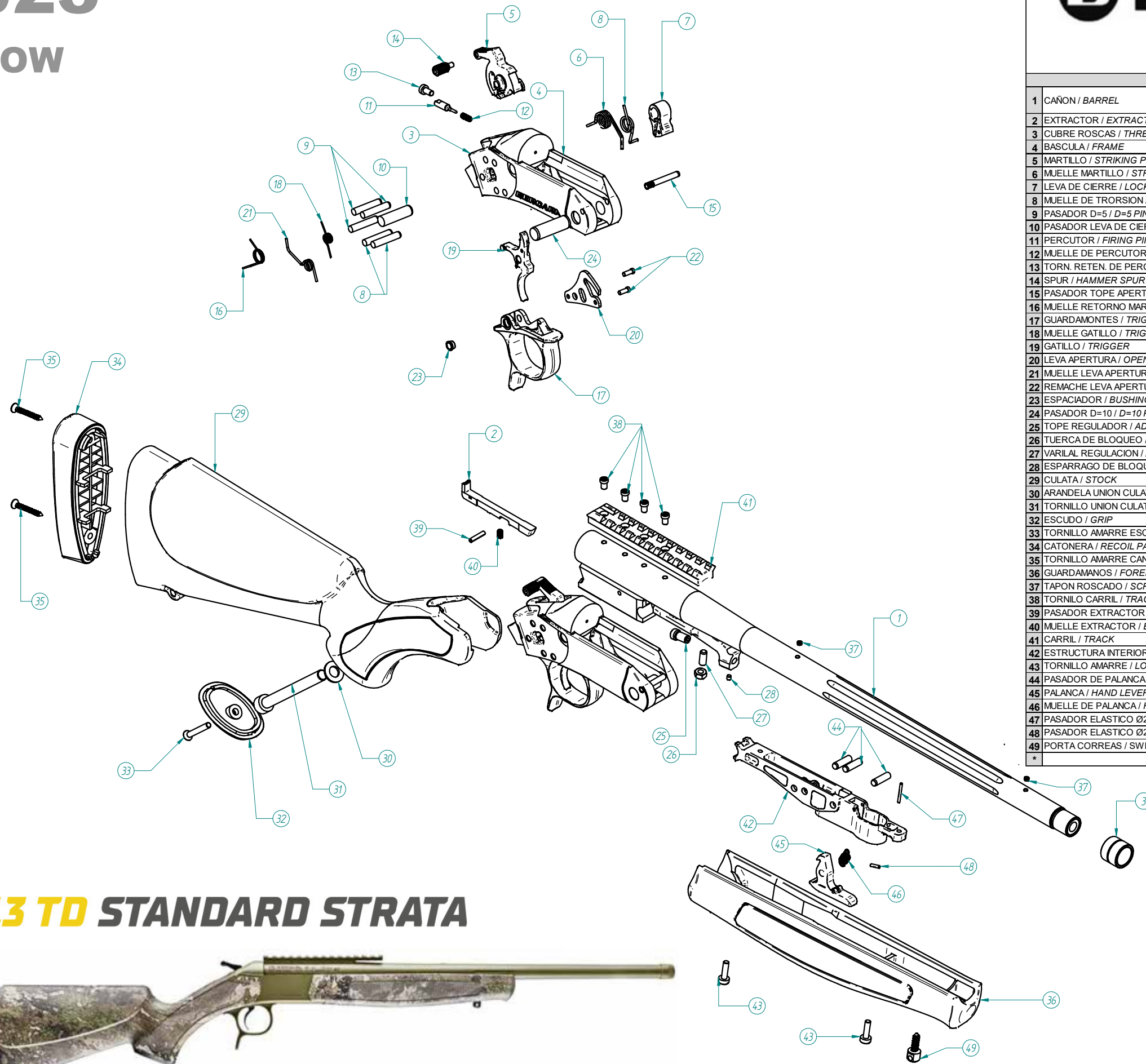

BA123-65ST
BA223-308ST



	Item	Description	6.5 Creed	308 Win
1	CAÑON / BARREL	TUBTD510CR 32194R-BA13TD-STDØ17,2[6.5CRP1:8E6L20C]PAV 5/8EU TUBTD502CR 32194R-BA13TD-STDØ17,2[308P1:12E6L20C]PAV 5/8EU	X	X
2	EXTRACTOR / EXTRACTOR	29955M EXPULSOR DE MM CAL.30-06	X	X
3	CUBRE ROSCAS / THREAD PROTECTOR	30582N CUBRE-ROSCAS	X	X
4	BASCULA / FRAME	BME TD002C 33162- BASCULA SC V2 TD BERGARA MECANIZADA NEGRA	X	X
5	MARTILLO / STRIKING PIECE	30952M STRIKING PIECE - SCOUT 2 M4x0,35	X	X
6	MUELLE MARTILLO / STRIKING PIECE SPRING	30965 MUELLE MARTILLO SCOUT 2	X	X
7	LEVA DE CIERRE / LOCKING LEVER	32588 LEVER - SCOUT V2	X	X
8	MUELLE DE TRORSION / TORSION SPRING	30949C MUELLE TORSION FUERTE - SCOUT V2	X	X
9	PASADOR D=5 / D=5 PIN	31909 PASADOR - PIN 5x24	X	X
10	PASADOR LEVA DE CIERRE / LOCKING LEVER PIN	31905 PASADOR EJE DEL CIERRE	X	X
11	PERCUTOR / FIRING PIN	31183 EJE PERC.	X	X
12	MUELLE DE PERCUTOR / FIRING PIN SPRING	31198 MUELLE DEL PERCUTOR DEL APEX	X	X
13	TORN. RETEN. DE PERCUTOR / FIRING PIN RETAIN SCREW	31182 TORNILLO M4x8 DIN-7984	X	X
14	SPUR / HAMMER SPUR	31721 SPUR SCOUT M4x0,35	X	X
15	PASADOR TOPE APERTURA / OPENING STOP PIN	31949 PASADOR TOPE SC 2	X	X
16	MUELLE RETORNO MARTILLO / HAMMER RETURN SPRING	30982 MUELLE RETORNO SCOUT 2ª GEN	X	X
17	GUARDAMONTES / TRIGGER GUARD	30948 GUARDAMONTE SCOUT-OPTIMA V2 NEGRO	X	X
18	MUELLE GATILLO / TRIGGER SPRING	30944 PULLING PIECES SPRING - SCOUT II	X	X
19	GATILLO / TRIGGER	30943 PULLING PIECE SCOUT 2	X	X
20	LEVA APERTURA / OPENNING LEVER	31455 GARFIO OPTIMA V2	X	X
21	MUELLE LEVA APERTURA / OPENNING LEVER SPRING	30945 OPENNING LEVER SPRING - SCOUT II	X	X
22	REMACHE LEVA APERTURA / OPENNING LEVEL FIXING PIN	31859 FIXING PIN - SC 2	X	X
23	ESPACIADOR / BUSHING	31950 CASQUILLO - BUSHING	X	X
24	PASADOR D=10 / D=10 PIN	31907 PASADOR - PIN	X	X
25	TOPE REGULADOR / ADJUST SCREW	31873 TOPE ROSCADO	X	X
26	TUERCA DE BLOQUEO / BLOCKING NUT	28288 TUERCA M-5 DIN 934	X	X
27	VARILAL REGULACION / ADJUST ROD	32163 VARILLA ROSCADA M5x12 DIN 913	X	X
28	ESPARRAGO DE BLOQUEO / BLOCKING ROD	31539 ESPARRAGO ALLEN M3x3 DIN 913	X	X
29	CULATA / STOCK	30449ST CULATA OPTIMA V2 CAMO TRUE TIMBER STRATA	X	X
30	ARANDELA UNION CULATA BASCULA / FRAME-STOCK WASHER	W503241 WASHER B 8.4 DIN 125 (BLUED)	X	X
31	TORNILLO UNION CULATA-BASCULA / FRAME STOCK BOLT	31908 TORNILLO UNION	X	X
32	ESCUDO / GRIP	30743 GRIP CAP BERGARA	X	X
33	TORNILLO AMARRE ESCUADO / GRIP CUP SCREW	32258 TORNILLO M4x30 DIN 966	X	X
34	CANTONERA / RECOIL PAD	29891B CANTONERA BERGARA - BREAK ACTIONCANTONER	X	X
35	TORNILLO AMARRE CANTOENRA / RECOIL PAD SCREW	10448 TOR. CAB. AVELL.3.5x30 DIN 7505A	X	X
36	GUARDAMANOS / FOREHAND	32156TTS FOREHAND SCOUT TD TUE TIMBER STRATA CAMO	X	X
37	TAPON ROSCADO / SCREW CAP	29256 TAPON ORIFICIO A-M	X	X
38	TORNILO CARRIL / TRACK SCREW	33145 TORNILLO TORX 8-40 UNS RAIL ACCESORIO	X	X
39	PASADOR EXTRACTOR / EXTRACTOR PIN	30209 PASADOR ESPIRAL DE 3 x 14 DIN 7343	X	X
40	MUELLE EXTRACTOR / EXTRACTOR SPRING	30238 MUELLE DEL EXTRACTOR	X	X
41	CARRIL / TRACK	40312 CARBON STEEL BARREL RAIL	X	X
42	ESTRUCTURA INTERIOR / INTERNAL STRUCTURE	32146B ESTRUCTURA INTERIOR	X	X
43	TORNILLO AMARRE / LOCKING SCREW	32145 TORNILLO M4x16	X	X
44	PASADOR DE PALANCA / HAND LEVER SPRING	31552 PASADOR DE PALANCA DE GUARDAMANO	X	X
45	PALANCA / HAND LEVER	32155 PALANCA	X	X
46	MUELLE DE PALANCA / HAND LEVER SPRING	32152 MUELLE PALANCA	X	X
47	PASADOR ELASTICO Ø2x16 / Ø2x16 ELASTIC PIN	32150 PASADOR ELASTICO Ø2x16 DIN7343	X	X
48	PASADOR ELASTICO Ø2x8 / Ø2x8 ELASTIC PIN	32151 PASADOR ELASTICO Ø2x8 DIN7343	X	X
49	PORTA CORREAS / SWIVEL SCREW	29116 BACK SCREW	X	X
*		E210 CERAKOTE E-210 ELITE MOSS	X	X

BA13 TD STANDARD STRATA

